



CORONA



Model description

The base Corona comes with a 4-cylinder diesel engine with 170 HP / 125 kW. This tried-and-true engine allows for a comfortable and reliable driving experience. Alternatively, if you require a bit more power, it is also possible to order a 190 PS / 140 kW diesel engine. The now standard MBUX system allows for entertainment on board as well as a safe travel with its integrated navigation.

Of course, we also offer a variety of optional equipment outside the standard equipment of our base models. The optional equipment ranges from four-wheel-drive through LED-headlights to multimedia systems.

The Corona also comes with a special suspension that includes enhanced stabilizers and shock absorbers, which further increases your safety while driving.

Base equipment:

- 170 HP / 125 kW engine (optionally 190 HP / 140 kW)
- 6-gear manual transmission (optionally 9-gear automatic)
- ESP, ABS and ASR
- Driving light- and side wind assistant
- Driver and passenger airbags
- Armrests in driver cabin seats
- Electrically adjustable windows
- Enhanced suspension variant
- Remote controlled central locking system, Keyless-Start
- Electrically adjustable, heated exterior mirrors
- MBUX 7" including navigation
- Adjustable multifunction steering wheel



Seating area

The cleverly designed seating area allows for a comfortable amount of space for each passenger.

- Two rotating Mercedes-Benz comfort seats in the driver's cabin
- Bench with 2 seats (Isofix included)
- Storage area under the bench
- Movable and optionally foldable table
- Newspaper rack (integrated in the side of the seating area)
- Flexible bottle holder
- Underfloor heating (Hot air streaming through the raised floor)
- Window in seating area: 90 x 55 cm
- Window in sliding door: 90 x 55 cm

Interior Room Concept

In order to make the compact base vehicle feel more spacious on the inside, we opted to design the interior furniture with a wide walkway, a bright and friendly living space as well as excellent ventilation. A large skylight as standard equipment is the natural choice for that.

The skylight, as well as all the windows, are insulated and come with integrated fly net and blind.

Large, liftable bed in the vehicle's roof

The Corona comes equipped with a large, liftable bed in the roof of the vehicle. Thanks to the hinge installed in the front, the bed can easily be raised and lowered using gas pressure dampeners. Pillows and other bed covering can simply be stored on the bed even when raised. The seating area below the bed can still be used while the bed is lowered.

- Bed length: ca. 210 cm
- Bed width: ca. 150 cm
- Space above the mattress: ca. 70 cm
- High quality MDI-foam mattress 10 cm
- Reading lights and USB-Outlets
- Storage pockets and Labos-rail
- Sideways windows on each side of the bed: 70 x 30 cm





Kitchen with a lot of storage space

- Two-flame gas cooker with efficient electric ignition
- Window size: 90 x 55 cm
- Stainless steel sink with covering
- Kitchen cupboard with multiple drawers
- Storage space and spice rack above workspace
- Trash bag
- Soft close



Furniture made to your liking

Because our vehicles are built by hand, we have full control over the interior design of the vehicle.

The Corona comes with heated flooring as standard equipment. This is achieved by having the hot air produced by the heater circulate through the raised floor and having vents on the end of the raised floor, allowing the hot air to flow in the front area as well.

The optional 95 cm Vario bench can be turned into an equally wide bed.

All of our furniture is made of 15mm poplar plywood with a high quality HPL front. Both the ceiling and the walls use a microfiber cloth covering. We use solid wood edges for all our furniture. It is also possible to order the table in the seating area in a foldable, solid wood variant. Solid wood frames are also available for all the windows.

- Several furniture decors and flooring options
- Solid wood edges available in multiple wood types
- Insulation 20 mm (X-Trem-Insulator)
- More than 20 upholstery options
- Solid wood fronts are also available
- Very robust and durable



Wetroom

To make sure that you feel at home in your camper van, we designed the wet room of the Corona as comfortable as possible. To accomplish this, we opted to design the wet room with a separate shower area. This shower tub is made of a high quality mineral based material called Getacore.

- Sink made of stainless steel (painted white)
- Special, high gloss wall covering
- Separate shower
- Extra space for shampoo bottles etc.
- Labos rail
- Makeup mirror
- Cassette toilet made by Truma
- Sideways window 50 x 30 cm

Rear Storage

The rear storage area can easily be accessed from the rear doors and offers a reasonable amount of space. You can also access your gas bottles from the rear.



Technology and equipment

- Heater boiler combination Truma Combi 4 (alternatively Truma Combi Diesel 6)
- Truma Frost protector for the heater boiler combination
- Truma MonoControl with Crash sensor
- Gas system with a 5 and a 11 kg gas bottle
- Water pressure system with a Shurflo water pump
- Interior fresh water tank 146 l
- Interior wastewater tank 78 l
- Compressor fridge 110 l
- Exterior LED lighting "Raintec", remote controlled

Environment

- EURO VI
- SCR-Catalyst
- Green Sticker
- Particle filter

Electronics

- Gel battery 235 Ah
- Multiple 230 V-, 12 V- and USB power plugs
- External 230 V plug with a 30 A electronic charger
- Charge booster 45 A and solar computer 350 W
- 12 V system with several LED lights
- Indirect lighting

Measurements

- Exterior length 5,93 m
- Height 3,14 m
- Width 2,00 m
- Wheelbase 3.665 mm
- Base weight ca. 3.062 kg
- Gross weight 3.500 kg (optional 4.100 kg)

Version 07/2021

Pictures displayed may contain optional equipment.
SPRINTER is a registered Trademark of the Daimler AG.

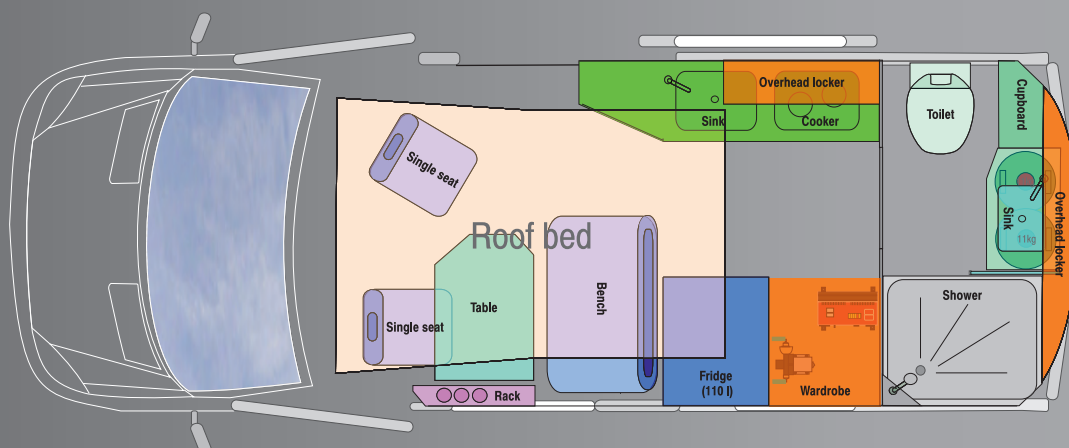

Building customer oriented caravans since 1985.

Ever since the founding of our family business, all the members of the CS-Team work on further improving our already high standard of quality

Because of this, we were able to create new standards in the compact caravanning class

We construct each CS caravan with a high degree of flexibility and can fit the interior to your needs.

Feel free to visit us for an in-depth discussion regarding our vehicles and make use of our experience.

CS-REISEMOBILE

Krögerskoppel 5
24558 Henstedt-Ulzburg

Tel.: +49 41 93 / 76 23-0
info@cs-reisemobile.de

Opening hours:

Monday - Thursday: 8.00 am - 5.00 pm
Friday: 8 am - 4 pm or by arrangement

www.cs-reisemobile.de



Our distributors:

SYRO Reisemobil Center

Gottlieb-Daimler-Str.1
59439 Holzwickede (Dortmund/Airport)
Tel.: 0 23 01 / 94 79 80 0
info@syro-reisemobile.de · syro-reisemobile.de

Tartaruga AG

Gewerbestrasse 1 · CH-8451 Kleinandelfingen
Tel.: 0 52 / 31 74 04 0 · Fax. 0 52 / 31 74 06 0
info@tartaruga.ch · www.tartaruga.ch

Le Fourgonneur

48, rue du Moulin Rouge · FR-85000 La Roche sur Yon
Tel.: 025 / 10 69 75 1
info@le-fourgonneur.com · www.le-fourgonneur.com